

BioStamp



INSTRUCTIONS MANUAL

CE

► **TABLE OF CONTENTS** ◀

1 - Introduction.....	1
2 - Pack content.....	1
3 - Installation.....	1
4 - Instructions for use.....	1
5 - Troubleshooting.....	2
6 - Maintenance and cleaning.....	2
7 - Technical specifications.....	3
8 - Symbology.....	3
9 - Warranty term and technical support.....	3
10 - Authorized representative in Europe.....	3
11 - Declaration of conformity.....	4
12 - Instruction for product storage.....	4
13 - Operational methods to be followed in case of accidents or breakdowns.....	4

► 1 - INTRODUCTION ◀

The Biostamp Sealer of Bio-Art has PTC technology (Positive Temperature Coefficient) for the efficient control of the sealing temperature.

Works with rolls of paper of up to 300 mm wide, has operating lever with exclusive paper lock system and cutter for cutting in both directions.

► 2 - PACK CONTENT ◀

Biostamp Sealer (one unit).
Electric cable 2p+T (one unit).
Instruction Manual (one unit).

► 3 - INSTALLATION ◀

- The sealer is manufactured for the voltages of 127 or 220 VAC, without bivolt switching system and must be connected to the electric mains with grounding and bipolar protection devices.
- For installation of the roll of paper, simply place it on the concave part of the cabinet, making sure that the plastic surface of the paper faces up.
- Do not install the sealer on the same socket with other installed appliances, machines or equipments.
- When connecting the power cable to the electric mains, a "beep" sound will be heard indicating the correct electrical communication.

► 4 - INSTRUCTIONS FOR USE ◀

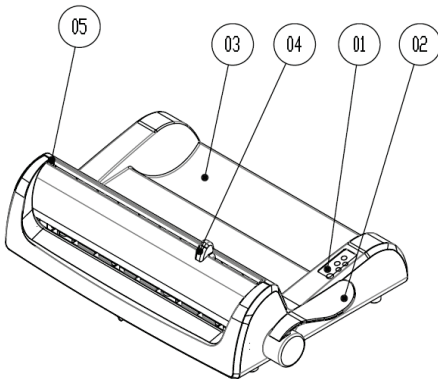

- 1 – Electric panel
- 2 – Operating lever;
- 3 – Paper roll compartment;
- 4 – Paper cutting blade carriage;
- 5 – Track fixation and release screw.

- 1 – To turn the BioStamp sealer on, press the On/Off key on the Electric panel. The green Led will come on intermittently indicating the time to heat the sealing unit;
- 2 – Wait for the green Led to change from intermittently to continuously on indicating that the machine is ready for use;
- 3 – To seal, insert the paper with the plastic side facing up inside the sealing system through the openings in the cabinet. Then operate the lever 180° in the anticlockwise direction, pressing and locking the paper. The red Led will then come on indicating the sealing process;
- 4 – Wait for the "beep" sound and the red Led change to intermittently on, indicating that the sealing has been successfully concluded;
- 5 – If necessary, cut the paper with the lever still activated by sliding the cutter to the end of the line;
- 6 – Return the lever to the initial position and the red Led will go off indicating that the machine is ready for new sealing.

Note:

- The blade carriage of the sealer cuts paper in both directions, sliding to both sides on the entire length of the paper. The cutting operation must be performed after sealing and always with the paper pressed;
- Do not operate the lever with the green Led intermittently on, and in case this occurs a sound and light alert signal will be given from the red Led;
- In case the lever does not return within 10 minutes or the machine is not activated for 60 minutes, it will be automatically turned off for safety purposes.

► 5 - TROUBLESHOOTING ◀

PROBLEMS	POSSIBLE CAUSE	SOLUTION
The sealer does not on when pressing the key on the electric panel, green Led remains off.	Lack of power in the sealer.	Check the electric mains, power cable and protection fuse.
Deficient sealing.	Sealer originally 220 V working in 127 V mains.	Check the voltage of the machine according to the electric mains.
	Deficient sealing time.	Do not return the lever before the red Led is intermittently on.
	Residues blocking the sealing unit.	Check possible obstructions through the paper insert window and carefully remove using a plastic spatula.
Paper burns and/or plastic melts during sealing.	Sealer originally 127 V working in 220 V mains.	Check the voltage of the machine according to the electric mains.
	Extended sealing time.	Return the lever when the red Led is intermittently on.

► 6 - MAINTENANCE AND CLEANING ◀

- 1 – To clean the cabinet, only use a dry soft cloth; do not use solvents, detergents or chemical products.
- 2 – Do not use metallic or sharp objects to clean any part of the BioStamp Sealer;
- 3 – The user should not perform any maintenance on the BioStamp Sealer, always use authorized technical support.

6.1 Fuse replacement.

- 1 - Disconnect the power supply cable from the socket and from the input connector before replacing the fuse;
- 2 – Insert a small screwdriver into the hole of the fuse holder drawer located in the input connector (AC) forcing it out and then pull the drawer;
- 3 – Check for two fuses, with the fuse further inside the drawer must be replaced by the spare one located behind it;
- 4 – Return the fuse drawer until it is completely inserted;
- 5 – Return the power cable and turn the machine on to check if it is working correctly.

Attention:

- If the fuse still causes problems, seek Authorized Technical Support;
- Always keep a spare fuse in the fuse holder and only use standard fuse Ø5x20mm 6A/250V.

6.2 – Replacement of paper cutting blades.

It is not necessary to dismount the cabinet of the machine in order to replace the paper cutting blades; follow the procedures below and only remove the track and the blade carriage assembly in order to replace the cutting blades.

- 1 – Disconnect the power cable;
- 2 – Position the blade carriage (04) completely to the right side of the track;
- 3 – Release the track fixation and release screw (05) in the anticlockwise direction until the track is detached from its support, and the head of the screw (05) is exposed in the cabinet to be used for manually moving the track;
- 4 – After releasing the track, hold the exposed head of the screw (05) with the left hand and hold the blade carriage (04) with the right hand. Through the screw (05), move the track to the right releasing it from the insert of the support on the left side;
- 5 – Push angularly the left side of the track upwards until it is released from the plastic cabinet chute. Then drag the track out and to the left, releasing the track from the support on the right side and remove the entire assembly from the machine;
- 6 – With the assembly out of the machine, remove the carriage (04) from the track and replace the blades;
- 7 – Reposition the carriage of the blades on the track and return the assembly into the machine proceeding inversely to the aforementioned.

► 7 - TECHNICAL SPECIFICATIONS ◀

Supply Voltage:..... 127 or 220VAC 50/60Hz
Working power:..... 300W* - (*PTC Positive Temperature Coefficient)
Sealing width:..... 12mm3
Initial heating time:..... 3' 30" minutes
Sealing time:..... 6" seconds
Sealing length:..... 300mm (maximum)
Machine dimensions (WxDxH):..... 460 x 300 x 125 mm.
Packaging dimensions (WxDxH):.. 500 x 320 x 160mm.
Weight without packaging:..... 3,600 Kg
Weight with packaging:..... 4,600 Kg.

► 8 - SYMBOLOGY ◀

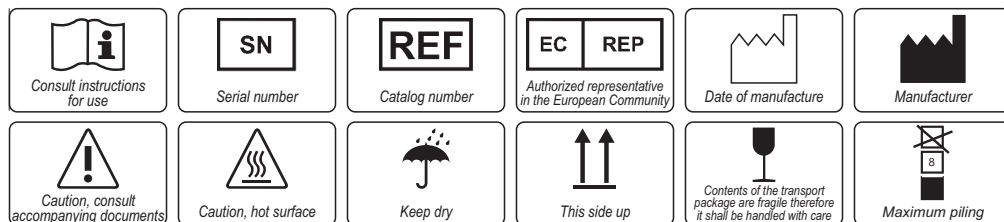

► 9 - WARRANTY TERM AND TECHNICAL SUPPORT ◀

Bio-Art Equipamentos Odontológicos Ltda., grants 1 (one) year warranty, starting from the date of the device purchase (invoice). The warranty is carried out exclusively by the authorized distributor and includes any manufacturing defect, being provided through the repairing of the product and subjected to the following requirements:

- That the product has been used correctly in accordance with the instructions described in the user manual;
- The claim is followed by the invoice and registered within the warranty period, accompanying a report with description of the damage and product serial number;
- The product is handled, transported and stored with care;
- The costs of transport (from and to) is paid by the customer;

Warranty limitations:

- Natural wears and tear of parts;
- Misuse, falls or accidents;
- Inadequate transportation;
- Repair by unauthorized person;
- Use in disagreement with the features and purposes of the device;
- Wear from exposure to adverse conditions (humidity, cold and heat);
- Damage from lack of cleaning or maintenance with inappropriate products.

In case of doubt, contact the manufacturer:

 **BIO-ART EQUIPAMENTOS ODONTOLÓGICOS LTDA.**
Rua Teotônio Vilela, 120 – Jardim Tangará – CEP 13568-000 – São Carlos – SP – Brasil
Tel. +55 (16) 3371-6502 – Fax +55 (16) 3372-5953 – www.bioart.com.br
CNPJ 58.538.372/0001-56 – Insc. Estadual 637.034.447.113

► 10 - AUTHORIZED REPRESENTATIVE IN EUROPE ◀

EC	REP
----	-----

Obelis s.a.
Boulevard Général Wahis 53 - 1030 Brussels, BELGIUM
Tel: +(32) 2.732.59.54 - Fax: +(32) 2.732.60.03
E-mail: mail@obelis.net

► 11 - DECLARATION OF CONFORMITY

This machinery fulfills all the relevant provisions of the European Council Directive 2006/42/EC (Machinery); of the Directive 2014/30/EU of 26 February 2014 (Electromagnetic compatibility) and of the Directive 2014/35/EU of 26 February 2014 (Low voltage).

European Harmonized Standards to which Conformity is Declared:

ISO 12100:2010 - Safety of Machinery - General principles for design - Risk assessment and risk reduction;

IEC/CISPR 14-1 Electromagnetic compatibility - Requirements for household appliances, electric tools and similar apparatus - Part 1: Emission;

IEC/CISPR 14-2 IEC/CISPR 14-2 Electromagnetic compatibility - Requirements for household appliances, electric tools and similar apparatus - Part 2: Immunity –Product standart;

EN 61000-4-2 Electrostatic discharge;

EN 61000-4-4 Electrical Fast transient and burst;

EN 61000-4-6 Conducted disturbance induced by RF fields;

EN 61000-4-5 Surges test;

EN 61000-4-11 Electromagnetic compatibility (EMC) Testing and measurement techniques;

IEC 61010-1:2010 Safety requirements for electrical equipment for measurement, control, and laboratory use - Part 1: General requirements;

IEC 61010-2:2003 Safety requirements for electrical equipment for measurement, control, and laboratory use - Part 2-010: Particular requirements for laboratory equipment for the heating of material.

► 12 - INSTRUCTION FOR PRODUCT STORAGE

This product must be stored in a covered place, at room temperature, protected against accidental falls and impacts.

► 13 - OPERATIONAL METHODS TO BE FOLLOWED IN CASE OF ACCIDENTS OR BREAKDOWNS

In case of accidents or breakdowns, send the product to Technical Assistance.



BIO-ART EQUIPAMENTOS ODONTOLÓGICOS LTDA.

📍 Rua Teotônio Vilela, 120 - Jardim
Tangará - CEP 13568-000
São Carlos - SP - Brasil

☎ (16) 3371-6502
🌐 www.bioart.com.br
📷 [bioart_solucoes_inteligentes](#)